

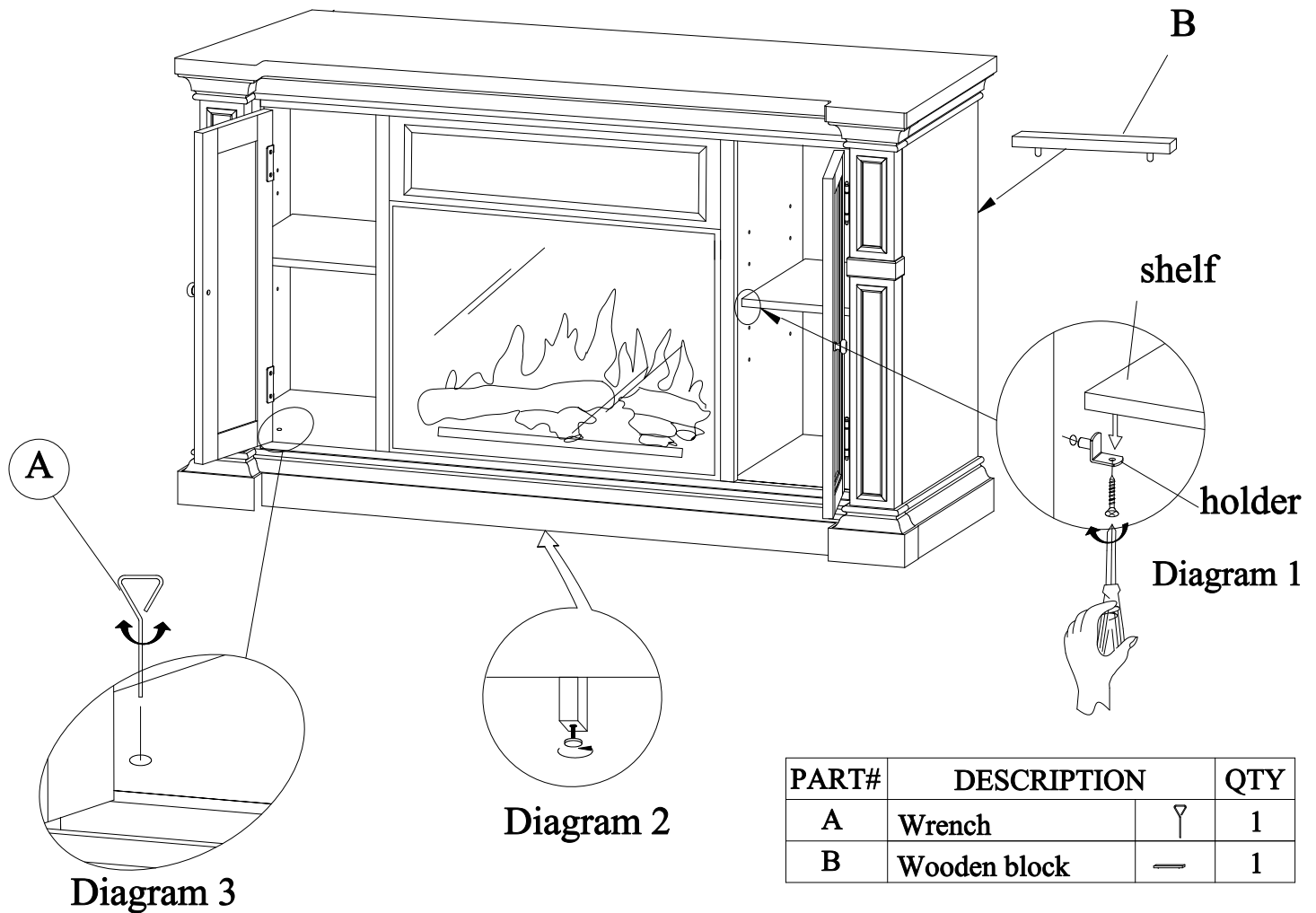

Berkshire Assembly Instructions

ZG-B1960 - Fireplace Wall Console



PART#	DESCRIPTION		QTY
A	Wrench		1
B	Wooden block		1

1. Remove fireplace insert from its box.
2. Slide fireplace into cabinet from the back.
3. Place the wooden block (B) behind the fireplace to keep it in place.
4. The wooden shelf is installed at the factory, but can adjusted with Phillip's Head screwdriver. (Not included, see diagram 1)
5. To level the cabinet on an uneven floor, adjust the levelers underneath the unit by hand. (See diagrams 2 & 3)

Thank you for choosing Legends Furniture!